

# Safety Instruction

Tormek Water Cooled Grinders run at a slow speed in water and are designed for maximum safety. However – as with all machines – there are some basic rules that must be followed to reduce the risk of fire, electric shock and personal injury. We ask you to read these instructions before you commence working with the machine. Save this instruction. Always use eye shields.

## Tormek T-8 Machine Label 230 V

**EN** Please read the instructions before operating the machine.

**SE** Vänligen läs instruktionsboken innan maskinen används.

230 V, 1~50 Hz. 200 W input/ineffekt, 90/min.

Continuous duty S1, Kontinuerlig drift S1.

Max stone diameter 250 mm.

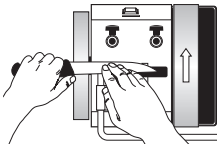

Always hone **away**  
from the edge

Bryna alltid **med**  
rotationsriktningen



Made in Sweden by Tormek AB, Lindsberg, [www.tormek.com](http://www.tormek.com)

## Tormek T-8 Machine Label 115 V

115 V, 1~50–60 Hz. 200 W (input), 100 RPM.

Continuous duty S1, Service en continu S1.

Working speed / Vitesse de travail 1.3 m/s.

Max diameter stone / de la meule Ø 250 mm.

Arbor size / diamètre de l'arbre Ø 12 mm.

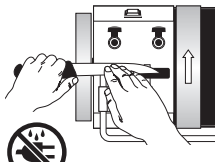

[www.tormek.com](http://www.tormek.com)

**EN** Always hone  
**away**  
from the  
edge

**FR** Toujours  
démorfiler **dans**  
le sens de rotation

**CONFORMS  
TO UL STD 987  
CERTIFIED  
TO CSA STD  
E1029.1 AND  
CSA E1029.2.4**



**Intertek  
3196221**

Made in Sweden / Fabriqué en Suède: Tormek AB, 711 34 Lindsberg

**EN WARNING** Read the instructions before operating the machine. Do not use in area where children may be present. Do not make adjustments until the stone has stopped running. Wear eye protection. Use grinding wheel suitable for 150 RPM.

## Tormek T-4 Machine Label 230 V

ROTATION DIRECTION ROTATIONSRIKTNING



**TORMEK® T-4**  
**Water Cooled Sharpening System**

Please read the instructions before operating the machine.  
Vänligen läs instruktionsboken innan maskinen används.

---

Made in Sweden by Tormek AB, 711 34 Lindesberg, www.tormek.com

ROTATION DIRECTION ROTATIONSRIKTNING

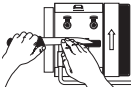

Always hone away from the edge  
Bryna alltid med rotationsriktningen

**!**

230 V, 1–50 Hz  
120 W  
120 r/min  
30 min/30 min  
Max stone  $\varnothing$  200 mm



ROTATION DIRECTION ROTATIONSRIKTNING

Stone  $\varnothing$  mm

## Tormek T-4 Machine Label 115 V

ROTATION DIRECTION SENSE DE ROTATION



**TORMEK® T-4**  
**Water Cooled Sharpening System**

Please read the instructions before operating the machine.  
Avant la mise en marche, étudier le mode d'emploi.

---

Made in Sweden by Tormek AB, 711 34 Lindesberg, www.tormek.com

ROTATION DIRECTION SENSE DE ROTATION

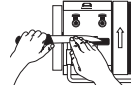

Always hone away from the edge  
Toujours démoifler dans le sens de rotation

**!**

115 V, 1–50-60 Hz  
120 W, 120 RPM  
Operation time 30 min/30 min  
Max stone/meule  $\varnothing$  200 mm  
Arbor size/arbre  $\varnothing$  12 mm



ROTATION DIRECTION SENSE DE ROTATION

Stone/Meule  $\varnothing$  mm



CONFORMS  
TO UL STD 987  
CERTIFIED TO  
CSA STD C22.2  
NO 71.2-08

### Mounting the Grinding Wheel

To avoid damage in transport, the grinding wheel is not mounted at the factory. Remove the left threaded EzyLock washer nut by turning clockwise. Remove the black distance sleeve from the main shaft. Mount the wheel and the EzyLock nut by hand. Do not overtighten the nut by using a tool. Use only flange and nut furnished with the grinder. The EzyLock nut will automatically tighten to the right force during the first sharpening operation.

### Dismounting the Grinding Wheel

To untighten the nut hold the leather honing wheel with one hand and turn the grinding wheel with your other hand clockwise. Remove the EzyLock nut and the grinding wheel by hand.

### Condition of the Machine

- Before using the machine it should be checked to determine that it will operate properly and perform its intended function. Do not use the machine if the switch does not turn it on and off.

- Inspect the cord set periodically and if damaged have it exchanged by qualified personnel. This is also valid for an extension cable if used.
- Replace a cracked wheel immediately.
- Disconnect the machine from the power supply before servicing and when changing the grindstone or the honing wheel.
- Only use Tormek original grinding wheels. For the T-8 model max. diameter 250 mm (10") and max. width 50 mm (2"). For the T-4 model the max. diameter is 200 mm (8") and max. width 40 mm (1½").
- Do not snatch the cable when pulling it out from the socket. Ensure that the cable is kept away from sharp edges, oil or heaters.
- Do not allow the grindstone to wear too much. Min. diameter for the T-8 model is approx. 200 mm (8"). For the T-4 model the min. diameter is approx. 150 mm (6").

### **Place of Work**

- Connect the machine to an earthed power supply with the voltage and Hz, which is written on the machine shield.
- If you use the machine outdoors and if you use an extension cable, the extension cable must be approved for outdoor use.
- Do not use the machine close to inflammable gases or liquids or in a dangerous environment, e.g. wet locations and do not expose it to rain.
- Ensure that any tools (e.g. spanners or adjustable wrenches) are removed from the grinding machine before turning it on.
- The machine should be operated on a flat, stable surface. Secure the machine with a clamp if there is any tendency for the tool to tip over, slide, or walk on the supporting surface. Frequently clean grinding dust from beneath grinder. Keep work area clean. Cluttered areas and benches invite accidents. Keep work area well lit.
- All children or visitors should be kept at a safe distance from the work area.
- Make workshop kid proof with padlocks or master switches.

### **Grounding Instructions**

- In the event of a malfunction or breakdown, grounding provides a path of least resistance for electric current to reduce the risk of electric shock. This tool is equipped with an electric cord having an equipment-grounding conductor and a grounding plug. The plug must be plugged into a matching outlet that is properly installed and grounded in accordance with all local codes and ordinances.
- Do not modify the plug provided – if it will not fit the outlet, have the proper outlet installed by a qualified electrician.
- Improper connection of the equipment-grounding conductor can result in a risk of electric shock. The conductor with insulation having an outer surface that is green with or without yellow stripes is the equipment-grounding conductor. If repair or replacement of the electric cord or plug is necessary, do not connect the equipment-grounding conductor to a live terminal.

- Check with a qualified electrician or service personnel if the grounding instructions are not completely understood, or if in doubt as to whether the tool is properly grounded.
- Use only 3-wire extension cords that have 3-prong grounding plugs and 3-pole receptacles that accept the tool's plug.
- Repair or replace damaged or worn cord immediately.
- This machine is intended for use on a circuit that has an outlet that looks like the one illustrated in Sketch A in Figure 82.1. The tool has a grounding plug that looks like the plug illustrated in Sketch A in Figure 82.1. A temporary adapter, which looks like the adapter illustrated in Sketches Band C, may be used to connect this plug to a 2-pole receptacle as shown in Sketch B if a properly grounded outlet is not available. The temporary adapter should be used only until a properly grounded outlet can be installed by a qualified electrician. The green-colored rigid ear, lug, and the like, extending from the adapter must be connected to a permanent ground such as a properly grounded outlet box.

**Figure 82.1**  
**Grounding methods**

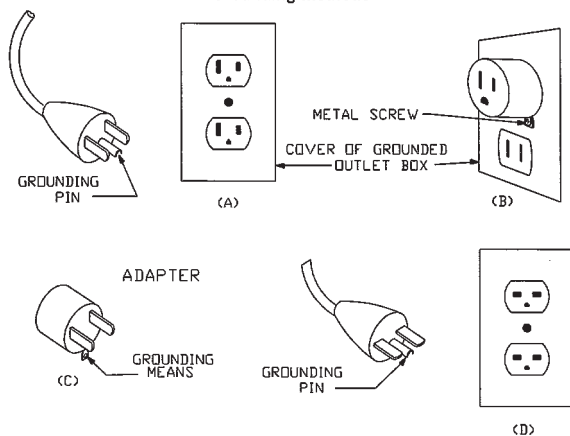

### Sharpening and Honing

- Only use the machine for the purpose it is designed for. Follow the instruction in the handbook.
- Use the right jig for each tool. Don't force the jig or attachment to do a job for which it was not designed.
- Don't force the machine. It will do the job better and safer at the rate for which it was designed.
- Make sure your hands are dry and clean from grease and oil.
- Do not lift the machine by gripping the Universal Support – it could pull out and allow the machine to drop.

- Do not wear loose clothing, gloves, neckties, rings, bracelets etc., which can get caught in the moving parts.
- Keep long hair covered or tied back. Non slip footwear is recommended.
- Keep a secure footing and balance when working with the machine.
- Avoid body contact with earthed objects (e.g. pipes, radiators, refrigerators, stoves etc.).
- Only use Tormek original jigs and accessories. Use of other accessories than those, which are recommended in this instruction can be a danger for the user.
- Only use the jigs in the way it is shown in the instructions. Ensure that your hands and fingers are kept away from the area between the universal support and the grindstone.
- The Tormek jigs and accessories are especially designed for Tormek machines and must not be used on any other grinder.
- Always keep a part of the tool on the grindstone during grinding – do not let it wholly slip outside the stone.
- Do not press the tool harder against the grindstone than that which enables you keep full control of the grinding operation.
- Ensure that you have full control of your work. Use common sense and do not use the machine when you are tired.

### Rotation Direction

Grinding:

When working free-hand, grind in the direction of rotation, i.e. *away from the edge*.

Honing:

Always hone in the direction of rotation (*away from the edge*), otherwise the edge can cut into the wheel.

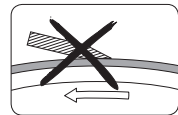
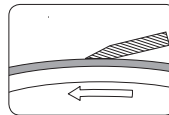
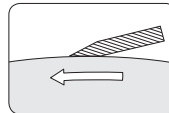

### Maximum Distance of Tool Rest

When using the Tool Rest SVD-110 or the Universal Support as a tool rest, the distance must not exceed 2 mm ( $\frac{3}{32}$ " ) between the support and grinding wheel. Adjust the support as the grindstone wears.

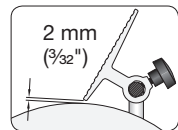
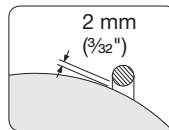

**After the Work**

- Never leave the machine running unattended.
- Do not leave a wet grindstone in temperatures below freezing point.
- Store the machine in a locked room and out of reach of children and unauthorized persons.

**Spare Parts and Repairs**

The machine complies with the relevant safety rules. Repairs should only be carried out by qualified persons using original spare parts, otherwise this may result in considerable danger for the user. If qualified personal is not available, contact the Tormek agent in your country. These are listed on the Tormek web site [www.tormek.com](http://www.tormek.com).

**Sound Level**

Sound pressure level ( $L_{pA}$ ) 59 dB(A)

Sound power level ( $L_{WA}$ ) 54 dB(A)

## Spare parts list – Tormek T-8

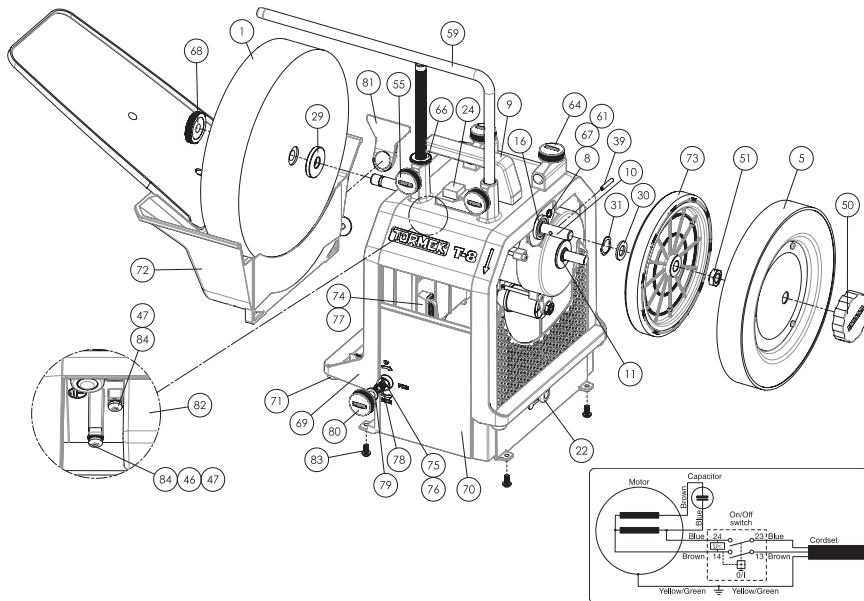

No.	Denomination	Qty	Art.no.	No.	Denomination	Qty	Art.no.
1	Grindstone	1	6011	55	Locking screw	2	7031
5	Honing wheel	1	0591-07	59	Universal Support excl. adjusting nut	1	0220
8	Mounting shaft	1	1015	61	* Distance spring for the motor	1	0561
9	Handle incl. nut and washer	1	3041	64	Locking screw	2	7120
10	** Main shaft	1	1041	66	Adjusting nut with scale	1	1162
11	Motor	1	6021 (230V) 6161 (115V)	67	* Bushing for mounting shaft	1	3123
16	Nylon bearing	2	3061	68	EzyLock	1	1190
21	* Cord set	1	6031 (SE) 6041 (CH) 6043 (US) 6050 (JP) 6053 (GB) 6055 (AU) 6057 (ZA)	69	Housing	1	2000
22	Cord set bushing	1	6081 (230V) 6191 (115V)	70	Plastic cover	1	3070 (230V) 3130 (115V)
24	Switch	1	6320 (230V) 6330 (115V)	71	Rubber foot	4	3198
29	Washer for the stone	1	0130	72	Water trough with water chute	1	3090
30	Washer for the drive wheel	1	5081	73	Drive wheel with friction ring	1	2010
31	Wave spring washer	1	5410	74	Water trough holder	1	2020
39	Locking pin	1	5071	75	Gear shaft	1	2070
46	Folded washer	2	5001	76	Locking head	1	2080
47	Locking washer	3	5021	77	Guide rail	2	3110
50	Locking knob for honing wheel	1	17041	78	Spring	1	0800
51	Nut. M12 h=4	1	1051	79	Washer 8.4×15×1.6 mm	1	5020
				80	Knob water trough	1	7005
				81	Scraper water trough	1	3100
				82	Cover for switch	1	3080
				83	Screw M5×10 mm	4	5590
				84	Screw M4×8 mm	3	5600

\* Not shown on drawing.

\*\* Available only with MSK-250.

## Spare parts list – Tormek T-4

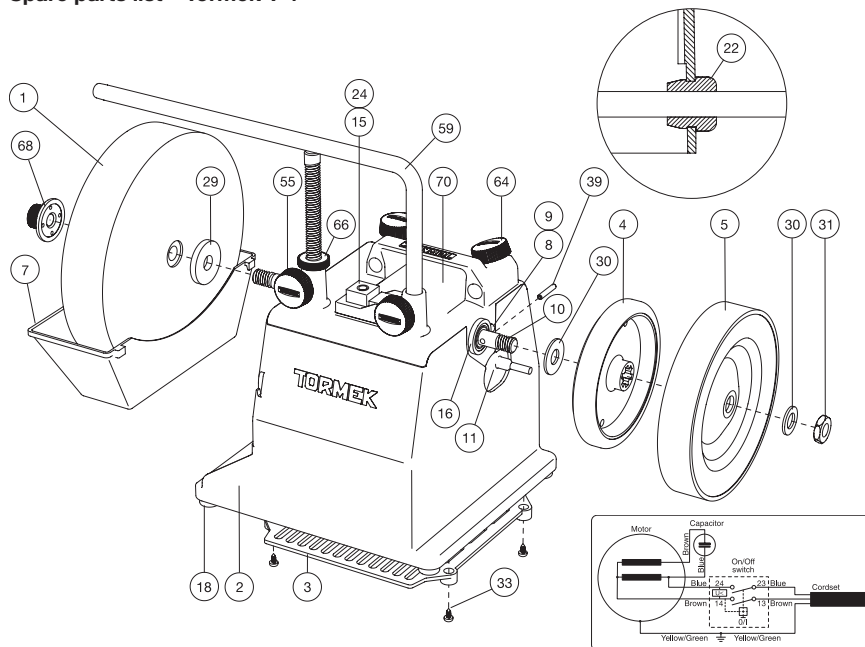

No.	Denomination	Qty	No.	Denomination	Qty
1	Grindstone	1	30	Washer for the drive wheel	2
2	Housing	1	31	Nut. M12 h=6	2
3	Grating	1	33	Screw for grating	4
4	Drive wheel with friction ring	1	39	Locking pin	1
5	Honing wheel	1	55	Locking screw	2
7	Water trough	1	59	Universal Support excl. adjusting nut	1
8	Mounting shaft	1	64	Locking screw	2
9	Locking ring	2	66	Adjusting nut with scale	1
10	** Main shaft	1	68	EzyLock	1
11	Motor 120 W	1	69	* Grounding wire connector	1
15	Cover for switch	1	70	Machine head	1
16	Nylon bearing	2			
18	Rubber foot	4			
20	* Machine label	1			
21	Cord set	1			
22	Strain relief	1			
24	Switch	1			
29	Washer for the stone	1			

\* Not shown on drawing.

\*\* Available only with MSK-200.